

### Stacklights

#### SL7 and SL4 range

The Eaton SL7 and SL4 stacklights provide reliable control over all key processes and machine availability. Available in two sizes, 70 mm (SL7) and 40 mm (SL4), the new stacklights are engineered to keep you informed about potential material requirements, downtime and hazards. Modules are available in a wide selection of audible, illuminating and mounting options that are well suited to adapt to any industrial application.



#### SL7 and SL4 stacklights

- Six lens colors: red, amber, yellow, green, blue, white
- Continuous, flashing, strobe and multi-strobe lighting functions
- Mono-tone, dual-tone and multi-tone audible alarms
- LED or incandescent lighting options
- Control up to five modules on a single stack, 10 with dual-arm base
- 24V, 120 Vac and 230 Vac operating voltages
- Simplified twist-and-lock assembly, no tools required
- Compact components reduce inventory requirements and increase flexibility
- Versatile hardware for quick installation and minimized downtime
- Slim 40 mm size (SL4) is ideal for applications with constrained space
- Lean automation with SmartWire-DT connectivity
- Ideal for indoor and outdoor usage
- Easily configurable components
- Simple bayonet mounting mechanism for quick assembly
- Flexible mounting and lighting options
- Volume-adjustable alarms
- Operating temperatures:  $-30^{\circ}$  to  $+60^{\circ}\text{C}$



As noise levels and distractions in today's production facilities continue to increase, a stacklight with the ability to demand your immediate attention is of utmost importance. You can count on the innovative audible and visual features of Eaton's SL series stacklights to keep you informed more reliably than ever before.

All six lamp modules are available with filament lamps, continuous light LEDs, flashing LEDs, strobe LEDs, or high-performance LEDs. This way, the modules brightness and colours can be adapted to the specific needs of customers and to varying international market requirements. The same holds true for the acoustic modules. 8 different signals and volumes that can be adjusted up to 100dB allow for optimal adaptation to an ambient condition

#### Disassemble

Signal towers can be disassembled in order to transport the corresponding machine. With Eaton's rapid mounting system this can be done in a matter of seconds.

1. Loosen the mounting ring
2. Remove the signal towers
3. Put the protection cap on.

Re-assembling and mounting the signal tower, both electrically and mechanically, is just as simple.

## Stacklights

### SL7 range

#### Complete devices

##### Continuous light, LED, UL type 4/4X/13, IP66

Rated operational voltage (Ue V)	Number of modules	Color	Function	Item no.
Base Module with Foot and 100 mm Tube				
24 Vac/Vdc	2	Red/Green		<b>SL7-100-L-RG-24LED</b>
	3	Red/Amber/Green		<b>SL7-100-L-RAG-24LED</b>



SL7-100-L-RG-24LED

#### Light Module with LED

##### Continuous light, UL type 4/4X/13, IP66

Rated operational voltage (Ue V)	Color	Function	Item no.
24 Vac/Vdc	Blue		<b>SL7-L24-B</b>
	Green		<b>SL7-L24-G</b>
	Red		<b>SL7-L24-R</b>
	White		<b>SL7-L24-W</b>
	Yellow		<b>SL7-L24-Y</b>
	Amber		<b>SL7-L24-A</b>
110/120 Vac	Blue		<b>SL7-L120-B</b>
	Green		<b>SL7-L120-G</b>
	Red		<b>SL7-L120-R</b>
	White		<b>SL7-L120-W</b>
	Yellow		<b>SL7-L120-Y</b>
	Amber		<b>SL7-L120-A</b>
230/240 Vac	Blue		<b>SL7-L230-B</b>
	Green		<b>SL7-L230-G</b>
	Red		<b>SL7-L230-R</b>
	White		<b>SL7-L230-W</b>
	Yellow		<b>SL7-L230-Y</b>
	Amber		<b>SL7-L230-A</b>



White



Amber



Yellow

##### Flashing light, UL type 4/4X/13, IP66, 2 Hz

Rated operational voltage (Ue V)	Color	Function	Item no.
24 Vac/Vdc	Blue		<b>SL7-BL24-B</b>
	Green		<b>SL7-BL24-G</b>
	Red		<b>SL7-BL24-R</b>
	White		<b>SL7-BL24-W</b>
	Yellow		<b>SL7-BL24-Y</b>
	Amber		<b>SL7-BL24-A</b>
110/120 Vac	Blue		<b>SL7-BL120-B</b>
	Green		<b>SL7-BL120-G</b>
	Red		<b>SL7-BL120-R</b>
	White		<b>SL7-BL120-W</b>
	Yellow		<b>SL7-BL120-Y</b>
	Amber		<b>SL7-BL120-A</b>
230/240 Vac	Blue		<b>SL7-BL230-B</b>
	Green		<b>SL7-BL230-G</b>
	Red		<b>SL7-BL230-R</b>
	White		<b>SL7-BL230-W</b>
	Yellow		<b>SL7-BL230-Y</b>
	Amber		<b>SL7-BL230-A</b>



Green



Blue



Red

## Stacklights

### SL7 range

#### Light module with LED

Strobe light, UL type 4/4X/13, IP66, 1.4 Hz



White



Amber



Yellow

Rated operational voltage (Ue V)	Color	Function	Item no.
24 Vac/Vdc	Blue		SL7-FL24-B
	Green		SL7-FL24-G
	Red		SL7-FL24-R
	White		SL7-FL24-W
	Yellow		SL7-FL24-Y
	Amber		SL7-FL24-A
110/120 Vac	Blue		SL7-FL120-B
	Green		SL7-FL120-G
	Red		SL7-FL120-R
	White		SL7-FL120-W
	Yellow		SL7-FL120-Y
	Amber		SL7-FL120-A
230/240 Vac	Blue		SL7-FL230-B
	Green		SL7-FL230-G
	Red		SL7-FL230-R
	White		SL7-FL230-W
	Yellow		SL7-FL230-Y
	Amber		SL7-FL230-A

#### SL7 Light module with high-output LED

Continuous light, UL type 4/4X/13, IP66



Green

Rated operational voltage (Ue V)	Color	Function	Item no.
High-performance LED for maximum signaling effect			
24 Vac/Vdc	Blue		SL7-L24-B-HP
	Green		SL7-L24-G-HP
	Red		SL7-L24-R-HP
	White		SL7-L24-W-HP
	Yellow		SL7-L24-Y-HP
	Amber		SL7-L24-A-HP



Blue

#### Strobe light, UL type 4/4X/13, IP66

Rated operational voltage (Ue V)	Color	Function	Item no.
High-performance LED for maximum signaling effect, 1.4 Hz			
24 Vac/Vdc	Blue		SL7-FL24-B-HP
	Green		SL7-FL24-G-HP
	Red		SL7-FL24-R-HP
	White		SL7-FL24-W-HP
	Yellow		SL7-FL24-Y-HP
	Amber		SL7-FL24-A-HP



Red

#### Multi-Strobe light, UL type 4/4X/13, IP66

Rated operational voltage (Ue V)	Color	Function	Item no.
High-performance LED for maximum signaling effect, 1–2.6 Hz			
24 Vac/Vdc	Blue		SL7-FL24-B-HPM
	Green		SL7-FL24-G-HPM
	Red		SL7-FL24-R-HPM
	White		SL7-FL24-W-HPM
	Yellow		SL7-FL24-Y-HPM
	Amber		SL7-FL24-A-HPM

## Stacklights

### SL7 range

#### SL7 Light module for incandescent bulb

Continuous light, UL type 4/4X/13, IP66

Rated operational voltage (Ue V)	Color	Function	Item no.
Without Light Elements, Incandescent Bulb, Maximum 7W			
<250 Vac/Vdc	Blue		<b>SL7-L-B</b>
	Green		<b>SL7-L-G</b>
	Red		<b>SL7-L-R</b>
	White		<b>SL7-L-W</b>
	Yellow		<b>SL7-L-Y</b>
	Amber		<b>SL7-L-A</b>

#### SL7 Acoustic modules

Continuous tone or pulsed tone, UL type 4/4X/13, IP66 ①

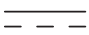
Rated operational voltage (Ue V)	Rated operational current (Ie mA)	Color	Function	Sound type	Item no.
Adjustable with internal DIP switches. Sound pressure 100 dB, adjustable with internal potentiometer. f = 2800 Hz.					
24 Vac/Vdc	Maximum 92	Black			<b>SL7-AP24</b>
110/120 Vac	Maximum 41				<b>SL7-AP120</b>
230/240 Vac	Maximum 43				<b>SL7-AP230</b>



SL7-AP24

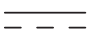

Continuous tone or pulsed tone, external actuation, UL type 4/4X/13, IP66 ①

Rated operational voltage (Ue V)	Rated operational current (Ie mA)	Color	Function	Sound type	Item no.
Assigned two inputs (two modules). Sound pressure 100 dB, adjustable with internal potentiometer. f = 2800 Hz.					
24 Vac/Vdc	Maximum 92	Black			<b>SL7-AP24-E</b>
110/120 Vac	Maximum 41				<b>SL7-AP120-E</b>
230/240 Vac	Maximum 43				<b>SL7-AP230-E</b>



SL7-AP120-E

Continuous tone or pulsed tone, external actuation, UL type 4/4X/13, IP66 ①

Rated operational voltage (Ue V)	Rated operational current (Ie mA)	Color	Function	Sound type	Item no.
Adjustable with internal DIP switch. Sound pressure 100 dB, adjustable with internal potentiometer. f = 500–2700 Hz.					
24 Vac/Vdc	Maximum 115	Black			<b>SL7-AP24-M</b>
110/120 Vac	Maximum 45				<b>SL7-AP120-M</b>
230/240 Vac	Maximum 43				<b>SL7-AP230-M</b>



SL7-AP230-M

① Place only at the highest position on a pole.

## Stacklights

### SL7 range

#### SL7 Base modules

For horizontal mounting—Includes cover, maximum 5 modules



SL7-CB-250



SL7-CB-EMH



SL7-CB-100



SL7-CB-FW



SL7-CB-D

Description	Tube length	Color	For use with..	Item no.
Base with aluminum tube and plastic foot Spring-loaded terminals	100 mm	Black	SL7-L...	<b>SL7-CB-100</b>
	250 mm	aluminum	SL7-BL...	<b>SL7-CB-250</b>
	400 mm	color tube	SL7-FL... SL7-AP...	<b>SL7-CB-400</b>
Base with aluminum tube and 3/4 in NPT threaded base Spring-loaded terminals	100 mm	Black	SL7-L...	<b>SL7-CB-T100</b>
	250 mm	aluminum	SL7-BL...	<b>SL7-CB-T250</b>
	400 mm	color tube	SL7-FL... SL7-AP...	<b>SL7-CB-T400</b>
Base with internal (on the inside) fixing holes Spring-loaded terminals		Black	SL7-L... SL7-BL... SL7-FL... SL7-AP...	<b>SL7-CB-IMH</b>
Base with built-in (pre-assembled) fixing screws Spring-loaded terminals		Black	SL7-L... SL7-BL... SL7-FL... SL7-AP...	<b>SL7-CB-IMS</b>
Base with external fixing holes Spring-loaded terminals		Black	SL7-L... SL7-BL... SL7-FL... SL7-AP...	<b>SL7-CB-EMH</b>
Base with base adapter for slipping onto place (rapid mounting and wiring system) Screw terminals	100 mm	Black	SL7-L...	<b>SL7-FMS-100</b>
	250 mm	aluminum	SL7-BL...	<b>SL7-FMS-250</b>
	400 mm	color tube	SL7-FL... SL7-AP...	<b>SL7-FMS-400</b>
Base with base adapter for slipping onto place (rapid mounting and wiring system) Blade terminal SWD4-8MF2 Maximum 0.3A per module External power supply connectable (24 Vdc) Configurable with SWD-Assist (planning and ordering help)	100 mm		SL7-L... SL7-BL... SL7-FL... SL7-AP...	<b>SL7-SWD</b>

For vertical mounting—includes cover, maximum 5 modules

Description	Tube length	Color	For use with..	Item no.
Vertical base with bracket Spring-loaded terminals		Black	SL7-L... SL7-BL... SL7-FL... SL7-AP...	<b>SL7-CB-FW</b>

For mounting on both sides—includes cover, maximum 2 x 5 modules

Description	Tube length	Color	For use with..	Item no.
Base with external fixing holes Spring-loaded terminals		Black	SL7-L... SL7-BL... SL7-FL... SL7-AP...	<b>SL7-CB-D</b>

## Stacklights

### SL7 range dimensions

Approx. dimension in Inches (mm)

#### Complete devices

SL7-100-LRG-24LED

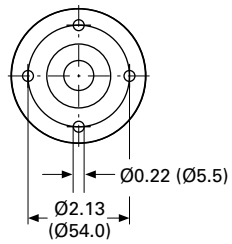
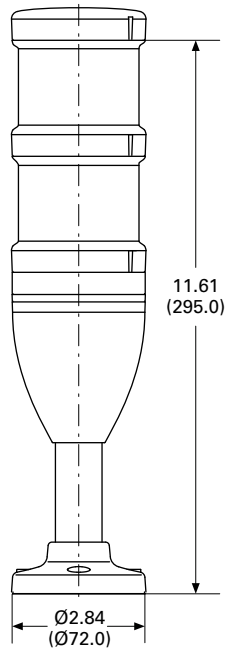

SL7-100-LRYG-24LED

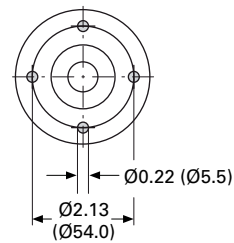
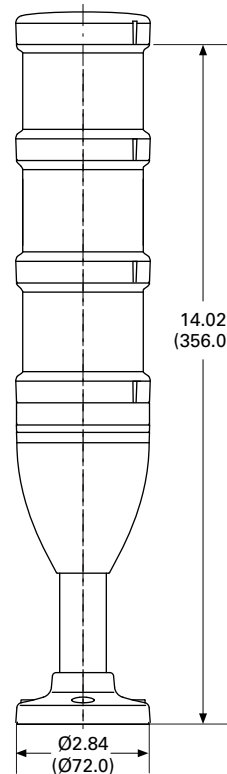

SL7-SWD

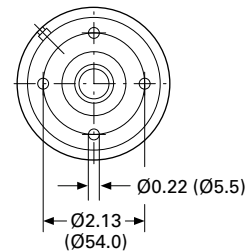
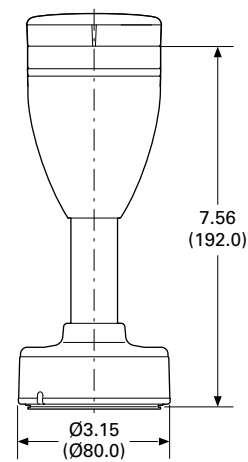

#### Light modules

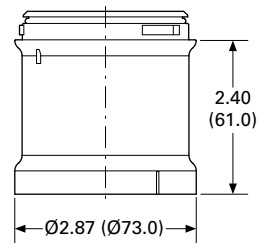

#### Acoustic modules

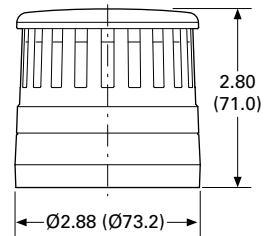

## Stacklights

### SL4 range

#### Complete devices

Continuous light, LED, UL type 4/4X/13, IP66



SL7-100-L-RG-24LED

Rated operational voltage (Ue V)	Number of modules	Color	Function	Item no.
Base Module with Foot and 100 mm Tube				
24 Vac/Vdc	2	Red/Green		<b>SL4-100-L-RG-24LED</b>
	3	Red/Amber/Green		<b>SL4-100-L-RAG-24LED</b>

#### Light module with LED

Continuous light, UL type 4/4X/13, IP66



White



Amber



Yellow



Green



Blue



Red

Rated operational voltage (Ue V)	Color	Function	Item no.
24 Vac/Vdc	Blue		<b>SL4-L24-B</b>
	Green		<b>SL4-L24-G</b>
	Red		<b>SL4-L24-R</b>
	White		<b>SL4-L24-W</b>
	Yellow		<b>SL4-L24-Y</b>
	Amber		<b>SL4-L24-A</b>
110/120 Vac	Blue		<b>SL4-L120-B</b>
	Green		<b>SL4-L120-G</b>
	Red		<b>SL4-L120-R</b>
	White		<b>SL4-L120-W</b>
	Yellow		<b>SL4-L120-Y</b>
	Amber		<b>SL4-L120-A</b>
230/240 Vac	Blue		<b>SL4-L230-B</b>
	Green		<b>SL4-L230-G</b>
	Red		<b>SL4-L230-R</b>
	White		<b>SL4-L230-W</b>
	Yellow		<b>SL4-L230-Y</b>
	Amber		<b>SL4-L230-A</b>

#### Flashing light, UL type 4/4X/13, IP66, 2 Hz



Rated operational voltage (Ue V)	Color	Function	Item no.
24 Vac/Vdc	Blue		<b>SL4-BL24-B</b>
	Green		<b>SL4-BL24-G</b>
	Red		<b>SL4-BL24-R</b>
	White		<b>SL4-BL24-W</b>
	Yellow		<b>SL4-BL24-Y</b>
	Amber		<b>SL4-BL24-A</b>
110/120 Vac	Blue		<b>SL4-BL120-B</b>
	Green		<b>SL4-BL120-G</b>
	Red		<b>SL4-BL120-R</b>
	White		<b>SL4-BL120-W</b>
	Yellow		<b>SL4-BL120-Y</b>
	Amber		<b>SL4-BL120-A</b>
230/240 Vac	Blue		<b>SL4-BL230-B</b>
	Green		<b>SL4-BL230-G</b>
	Red		<b>SL4-BL230-R</b>
	White		<b>SL4-BL230-W</b>
	Yellow		<b>SL4-BL230-Y</b>
	Amber		<b>SL4-BL230-A</b>

## Stacklights

### SL4 range

#### Light module with LED

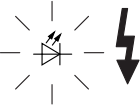
Strobe light, UL type 4/4X/13, IP66, 1.4 Hz

Rated operational voltage (Ue V)	Color	Function	Item no.
24 Vac/Vdc	Blue		SL4-FL24-B
	Green		SL4-FL24-G
	Red		SL4-FL24-R
	White		SL4-FL24-W
	Yellow		SL4-FL24-Y
	Amber		SL4-FL24-A
110/120 Vac	Blue		SL4-FL120-B
	Green		SL4-FL120-G
	Red		SL4-FL120-R
	White		SL4-FL120-W
	Yellow		SL4-FL120-Y
	Amber		SL4-FL120-A
230/240 Vac	Blue		SL4-FL230-B
	Green		SL4-FL230-G
	Red		SL4-FL230-R
	White		SL4-FL230-W
	Yellow		SL4-FL230-Y
	Amber		SL4-FL230-A



White



Amber



Yellow

#### Multi-strobe light, UL type 4/4X/13, IP66

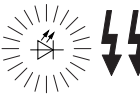
Rated operational voltage (Ue V)	Color	Function	Item no.
LED for effective signaling effect with various strobe sequences, 1–2.6 Hz			
24 Vac/Vdc	Blue		SL4-FL24-B-M
	Green		SL4-FL24-G-M
	Red		SL4-FL24-R-M
	White		SL4-FL24-W-M
	Yellow		SL4-FL24-Y-M
	Amber		SL4-FL24-A-M



Green



Blue

#### SL4 Light module for Incandescent bulb

Continuous light, UL type 4/4X/13, IP66



Rated operational voltage (Ue V)	Color	Function	Item no.
Without light elements, incandescent bulb, maximum 4W			
<250 Vac/Vdc	Blue		SL4-L-B
	Green		SL4-L-G
	Red		SL4-L-R
	White		SL4-L-W
	Yellow		SL4-L-Y
	Amber		SL4-L-A



Red

#### SL4 Acoustic modules

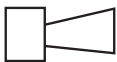
Continuous tone or pulsed tone, UL type 4/4X/13, IP66

Rated operational voltage (Ue V)	Rated operational current (Ie mA)	Color	Function	Sound type	Item no.
Adjustable with internal DIP switches. Sound pressure 80 dB, adjustable with internal potentiometer. f = 4000 Hz.					
24 Vac/Vdc	Maximum 39	Black			SL4-AP24
110/120 Vac	Maximum 21				SL4-AP120
230/240 Vac	Maximum 21				SL4-AP230



SL4-AP24



## Stacklights

### SL4 range

#### SL4 Base modules

For horizontal mounting—Includes cover, maximum 5 modules



SL4-PIB-<sub>...</sub>



SL4-PIB-IMH



SL4-PB-EMH



SL4-FMS-<sub>...</sub>



SL4-PIB-FW



SL4-PIB-D

Description	Tube length	Color	For use with..	Item no.
Base with aluminum tube and plastic foot Spring-loaded terminals	100 mm	Black	SL4-L...	<b>SL4-PIB-100</b>
	250 mm	aluminum	SL4-BL...	<b>SL4-PIB-250</b>
	400 mm	color tube	SL4-FL... SL4-AP...	<b>SL4-PIB-400</b>
Base with aluminum tube and 3/4 in NPT threaded base Spring-loaded terminals	100 mm	Black	SL4-L...	<b>SL4-PIB-T-100</b>
	250 mm	aluminum	SL4-BL...	<b>SL4-PIB-T-250</b>
	400 mm	color tube	SL4-FL... SL4-AP...	<b>SL4-PIB-T-400</b>
Base with internal (on the inside) fixing holes Spring-loaded terminals		Black	SL4-L... SL4-BL... SL4-FL... SL4-AP...	<b>SL4-PIB-IMH</b>
Base with built-in (pre-assembled) fixing screws Spring-loaded terminals		Black	SL4-L... SL4-BL... SL4-FL... SL4-AP...	<b>SL4-PIB-IMS</b>
Base with external fixing holes Spring-loaded terminals		Black	SL4-L... SL4-BL... SL4-FL... SL4-AP...	<b>SL4-PIB-EMH</b>
Base with base adapter for slipping onto place (rapid mounting and wiring system) Screw terminals	100 mm	Black	SL4-L...	<b>SL4-FMS-100</b>
	250 mm	aluminum	SL4-BL...	<b>SL4-FMS-250</b>
	400 mm	color tube	SL4-FL... SL4-AP...	<b>SL4-FMS-400</b>
Base with base adapter for slipping onto place (rapid mounting and wiring system) Blade terminal SWD4-8MF2 Maximum 0.3A per module External power supply connectable (24 Vdc) Configurable with SWD-Assist (planning and ordering help)	100 mm		SL4-L... SL4-BL... SL4-FL... SL4-AP...	<b>SL4-SWD</b>

For vertical mounting—includes cover, maximum 5 modules

Description	Tube length	Color	For use with..	Item no.
One-sided base with bracket Spring-loaded terminals		Black	SL4-L... SL4-BL... SL4-FL... SL4-AP...	<b>SL4-PIB-FW</b>

For mounting on both sides—includes cover, maximum 2 x 5 modules

Description	Tube length	Color	For use with..	Item no.
Base with external fixing holes Spring-loaded terminals		Black	SL4-L... SL4-BL... SL4-FL... SL4-AP...	<b>SL4-PIB-D</b>

**Stacklights**

**SL4 range dimensions**

Approx. dimension in Inches (mm)

**Complete devices**

SL4-100-LRG-24LED

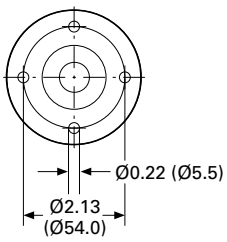
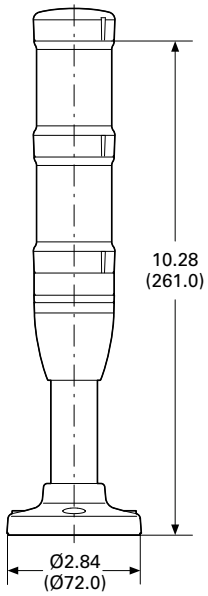

SL4-100-LRYG-24LED

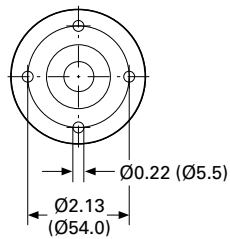
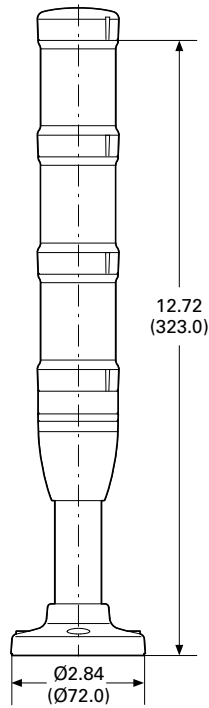

SL4-SWD

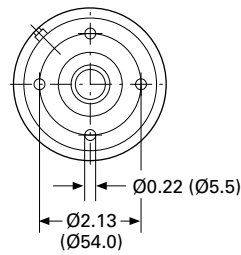
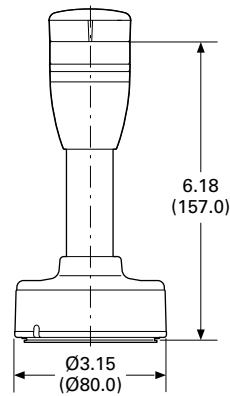

**Light modules**

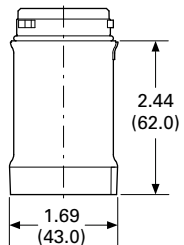

**Acoustic modules**

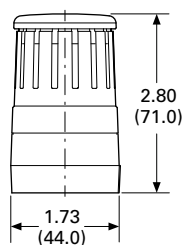

## Stacklights

### Stacklights - SL range accessories

#### Mounting brackets



SL7/4-FW

Description	For use with..	Item no.
Mounting brackets for vertical Mounting, plastic	SL4-PIB.. SL7-CB..	<b>SL7/4-FW</b>
M20 cable gland for vertical mounting, Metal (includes mounting bracket)	SL4-PIB-T.. SL7-CB-T..	<b>SL7/4-FW-T</b>



SL7/4-FW-T

#### Incandescent bulb tool

Description	For use with..	Item no.
Tool for replacing incandescent bulb	SL7-L.. SL4-L...	<b>SL7/4-BET</b>



SL7/4-BET

#### Incandescent bulbs

##### Mounting: Ba15d - SL7 series

Lifespan (h)	Rated operational voltage (Ue V)	Power (Watts)	For use with..	Item no.
3000	12	5	SL7-L...	<b>SL7-L12</b>
	24	6.5		<b>SL7-L24</b>
	120	7		<b>SL7-L120</b>
	230	6.5		<b>SL7-L230</b>



SL7-L12

##### Mounting: Ba15d - SL4 series

Lifespan (h)	Rated operational voltage (Ue V)	Power (Watts)	For use with..	Item no.
3000	12	4	SL4-L...	<b>SL4-L12</b>
	24			<b>SL4-L24</b>
	120			<b>SL4-L120</b>
	230			<b>SL4-L230</b>